

DOUBLE EGRESS DOORS & FRAMES

Double Egress Openings are designed to permit the flow of traffic in two directions through the same opening.

OPG	DIMENSIONS (4-1/2" Hinge)			
	1	2	3	4
6'8"	7-1/2"	37-7/16"	67-3/8"	N/A
7'0"	9-1/2"	39-7/16"	69-3/8"	N/A
7'2"	9-1/2"	40-7/16"	71-3/8"	N/A
7'10"	5"	29-7/8"	54-3/4"	79-5/8"
8'0"	5"	30-1/2"	56"	81-1/2"
10'0"	5"	38-1/2"	72"	105-1/2"

Top of Hinge

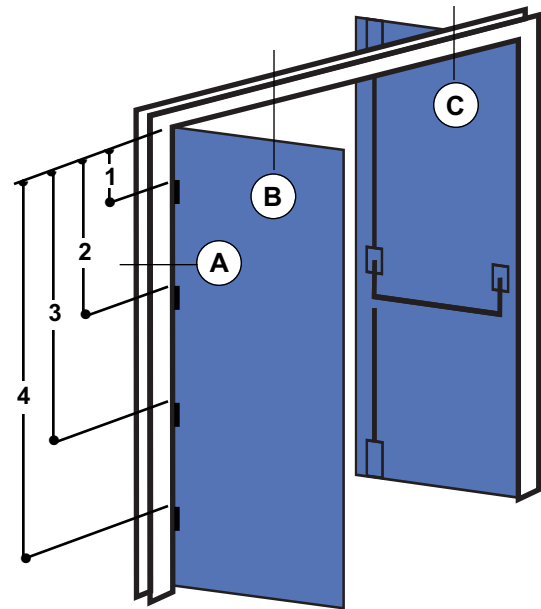

Typical Elevation

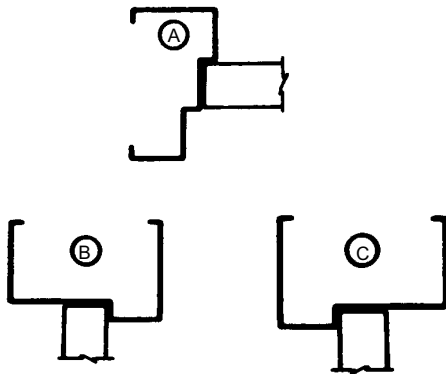

Header

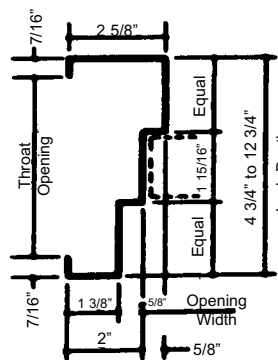
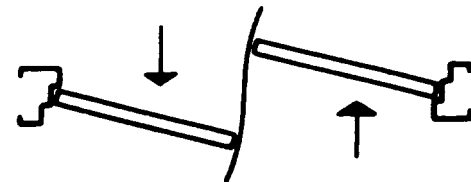

1 3/8" Face Standard

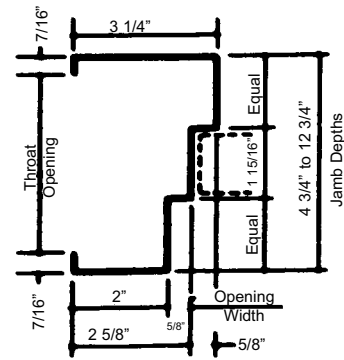

2" Face Optional

Rough Opening Required for Butted Frame
Door Width Opening + 2x <u>Smaller</u> Face Dimension + 2"
Door Height Opening + <u>Smaller</u> Face Dimension + 1/4"

Revised 8/09

A. Fire Labeled - Underwriters or Warnock Hersey openings to be supplied as a complete door and frame unit.

Series	Gage	THK	Hardware	Jamb Depths		Label Rating	DM Only	DE Only
				4-3/4 Min.	12-3/4 Max.		3Hr. 1-1/2Hr. 3/4Hr. 20 Min.	3Hr. 1-1/2Hr. 3/4Hr. 20 Min.
DOOR DM/DE	20,18,16	1-3/4	Two UL approved vertical rods	4-3/4 Min.	12-3/4 Max.	Max Door Size	8080-18 Ga.	8080 18 Ga. 6072 20 Ga. 8080 16 Ga.
FRAME ME	16 or 14					Max Glass Size	1296 Sq In. In 3/4Hr Doors	1296 Sq In. In 3/4Hr Doors

B. Non-Label

Series	Gage	THK	Hardware	Jamb Depths		Construction
DOOR DM/DE	20, 18 or 16	1-3/4	Optional	4-3/4 Min.	12-3/4 Min.	Frames to have welded or K.D. corners
FRAME ME	16 or 14					

ANCHOR DETAILS

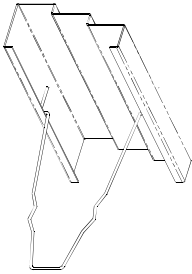

Wire Masonry Anchor

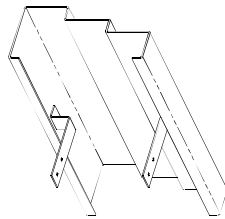

Wood Stud Anchor

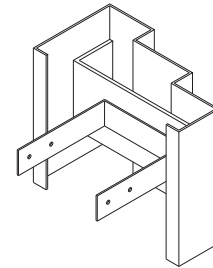

Wood Stud Anchor Single Piece

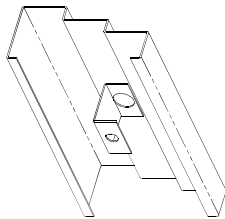

Prepared Opening Anchor

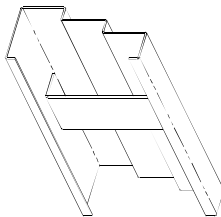

Steel Stud Anchor

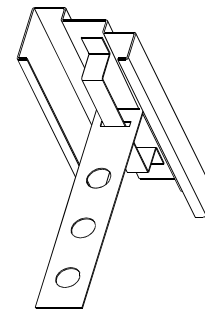

Adjustable Masonry Anchor

DOOR AND FRAME HANDING CHART

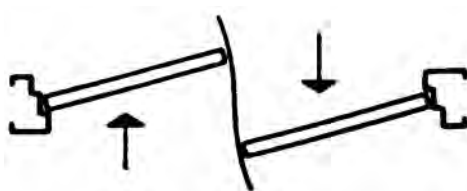

Left Hand Swing

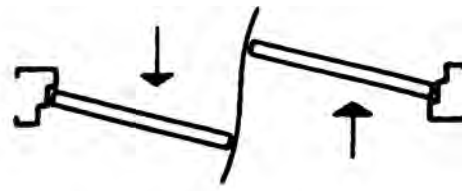

Right Hand Swing

All double egress openings shall be supplied as right hand swing unless otherwise specified.

Revised 6/05