

DL/DE SERIES STEEL STIFFENED DOORS

DL/DE Series Steel Stiffened Doors shall be as manufactured or furnished by Republic Doors and Frames, McKenzie, Tennessee 38201.

Thickness - 1-3/4"

Actual Door Size - Door undersized from nominal by 1/4" in width and 7/8" in height. Standard undercut is 3/4".

Hinge Rail & Reinforcement - Hinge edge is non-beveled and is reinforced with a continuous 10 gage steel channel projection welded at a maximum 5" on center. Hinge reinforcement is provided by the integral hinge channel. (Backset 1/4")

Lock Rail - Lock edge is beveled or non-beveled and reinforced with a continuous 14 gage steel channel projection welded at a maximum 5" on center. 16 gage reinforcements for mortise or cylindrical locks are of an integral type in accordance with ANSI A115 Standards. (Beveled 1/8" in 2" optional)

Top Channel - Top Channel is a flush 16 gage channel, projection welded at a maximum 2-1/2" on center.

Bottom Channel - Bottom Channel is an inverted 16 gage steel channel, projection welded at a maximum 2-1/2" on center.

Cores Available - Steel Stiffened, with mineral wool or fiberglass batt between each stiffener.

Stiffener Gages & Size - 20, 18 or 16 gage - 4" wide

Stiffener Spacing - Maximum 6" apart (Varies according to door width)

Stiffener Welding - 5" maximum on centers. (Vertically)

Face Skins - 18 gage, 16 gage and 14 gage.

Closer Reinforcement (Optional) - When closer reinforcements requested 14 gage standard / 12 gage optional. (18" x 6")

Size Availability - Minimum 2'0" x 2'0", Maximum 5'0" x 10'0" (Larger sizes available / consult factory)

SDI 100 Grade/Model - Grade 2 Models 1 & 2 (Heavy Duty minimum 18 gage, hollow steel)
Grade 3 Models 1 & 1A, 2 & 2A (Extra Heavy duty minimum 16 gage, hollow steel)

Label Range - Consult Label Section.

Continuous Welded Seam - Available - (Maximum Size 4'0" x 10'0"; Gages: 18, 16 & 14)

Universal Standard/Heavy Weight Hinge - Hinge fillers are used, allowing for an easy modification from heavy weight to standard weight hinge prep.

Handing Design - Non-Handed standard (Handed optional)

Revised 8/09

DL/DE SERIES STEEL STIFFENED DOORS (OPTIONS)

Face Skins-Galvanized: Republic's standard is a hot dipped process of not less than 0.6 oz of zinc per square foot (A60). Other types of zinc coating designations (G90) are available on request. The galvanizing process adheres to the criteria set forth by ASTM A924, ASTM A653/A653M and SDI 112-97. **Republic's standard supplied light kits or louvers for galvanized doors will be galvanized.**

Light Kits & Louvers-See Miscellaneous Section

Hinge & Strike Locations-Optional locations available. See Miscellaneous Section

Closer Reinforcement-When closer reinforcements requested 14 gage standard / 12 gage optional. (18" x 6")

Lock Edge-Beveled

Revised 8/09



DL/DE SERIES STEEL STIFFENED DOOR CONSTRUCTION DETAILS

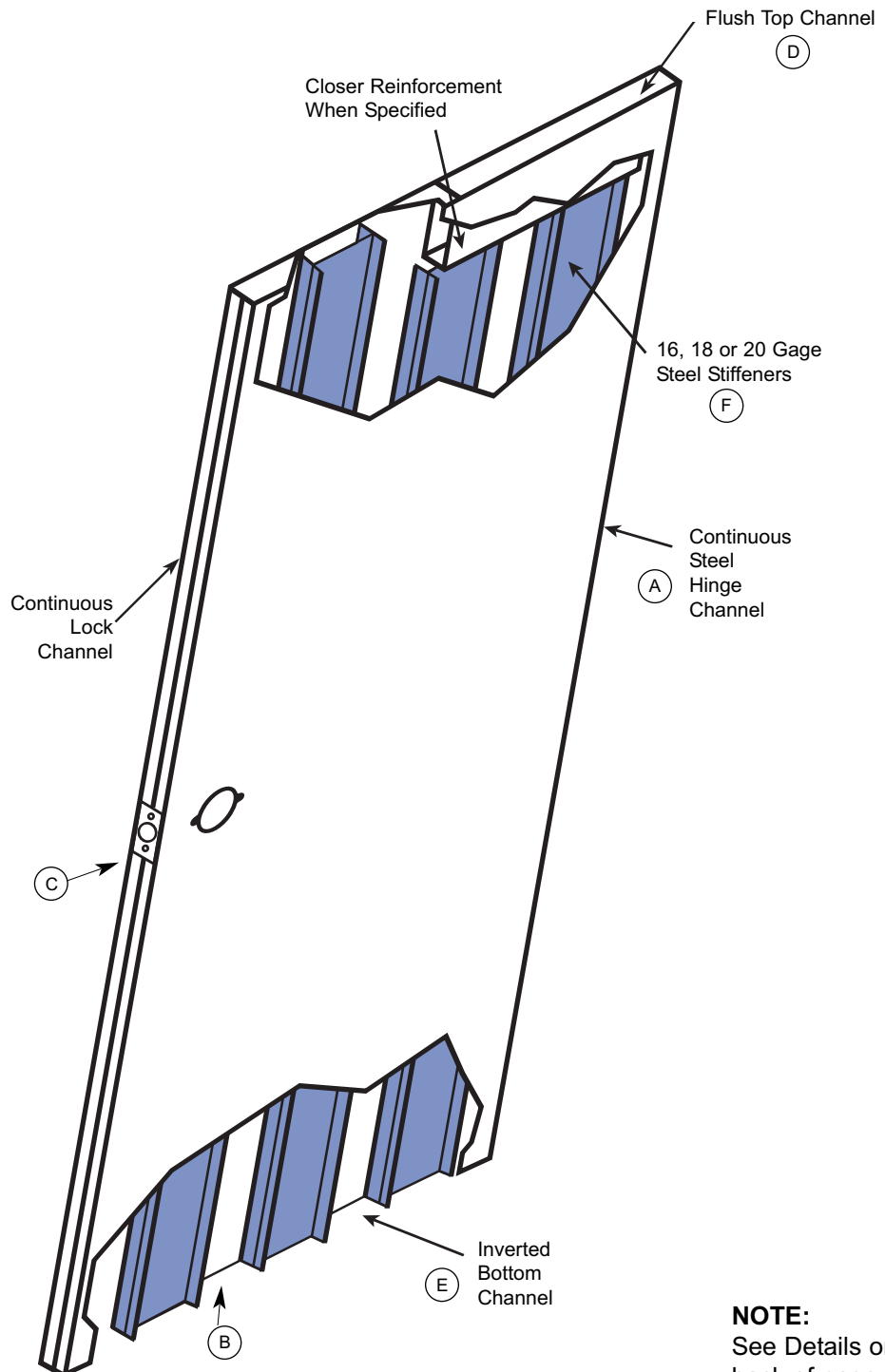

NOTE:
See Details on
back of page.

Revised 8/09

MEMBER OF:



Republic Doors and Frames

155 Republic Drive • McKenzie, Tennessee 38201 • (731) 352-3383

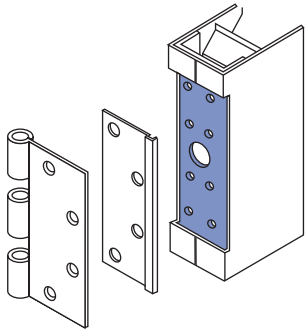

A

Continuous 10 gage steel channel reinforcement compatible with 4-1/12" or 5" full mortise template hinges on 1-3/4" doors or 3-1/2" x 3-1/2" full mortise template hinges on 1-3/8" doors

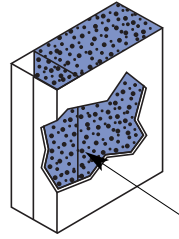
B

Fiber Glass Batts (Density 1.5 R-Factor 6.8 U-Factor .147) or Mineral Wool

C

14 gage continuous lock channel

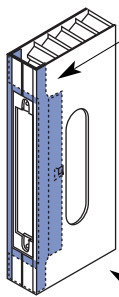

16 gage mortise lock reinforcement with provisions for Gov't Series 86 mortise lockset and ANSI A115.1 lock front (1-1/4" x 8")

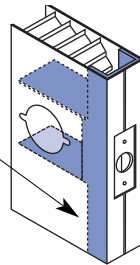

16 gage steel cylindrical lock reinforcement with provisions for Gov't Series 160 or 161 cylindrical lock sets (2-3/4" backset) and ANSI A115.2 lock front (1-1/8" x 2-1/4")

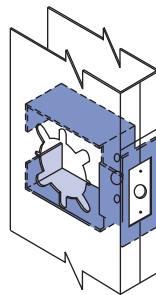

Lever Lock Prep - 161 DT (Modified 161 Prep) Conforms with the ANSI 115.18 161 lever lock specifications.

WARNING: Use rose trim with a minimum diameter of 3-5/16" to cover prep.

D

16 gage flush top steel channel

DOOR TOP

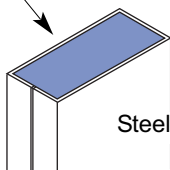

Steel Panel

When closer reinforcements requested 14 gage standard / 12 gage optional

E

DOOR BOTTOM

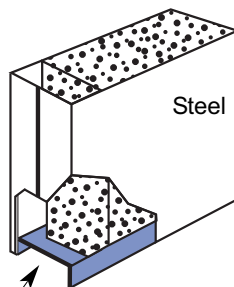

16 gage inverted bottom steel channel

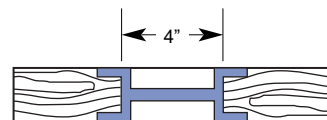
F

16, 18 or 20 gage Vertical Stiffener (4" wide)